

Flymo

DK 9645139

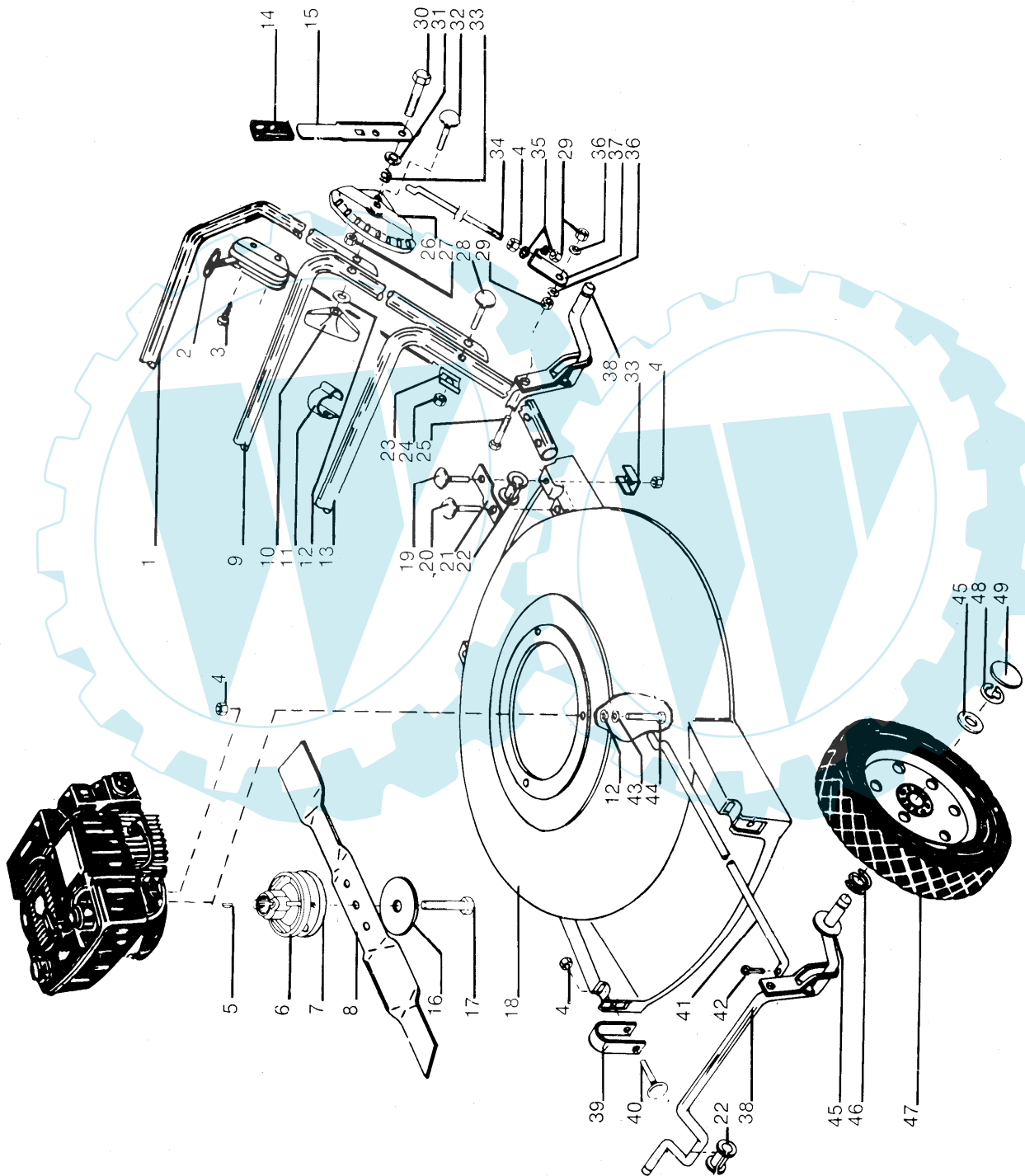

Flymo**DK 9645139**

KEY NO.	PART NO.	DESCRIPTION	QUANTITY	COMMENTS/ APPLICATION
1	515105549-00/7	HANDLE UPPER	1	
2	515202154-00/8	THROTTLE CONTROL COMPLETE	1	
3	515745035-00/3	SCREW	2	
4	515763008-00/7	NUT LOCK	11	
5	515117001-00/5	KEY WOODRUFF	1	
6	515131064-00/5	ADAPTOR BLADE	1	
7	515139579-00/4	SHIM	1	
8	5164139-00/7	BLADE 50 CM	1	
9	515105703-00/0	HANDLE CENTRE	1	
10	5168329-00/0	WING NUT	2	
11	515104379-00/0	CLIP	1	
12	515768012-00/4	WASHER BASE	6	
13	515105649-00/5	HANDLE LOWER	1	
14	515104472-00/3	FERRULE PLASTIC	1	
15	515139889-00/7	ARM HOC ADJUSTMENT	1	
16	515139753-00/5	WASHER	1	
17	515123930-00/7	BOLT BLADE	1	
18	515131093-00/4	CHASSIS	1	
19	515711840-00/6	BOLT LOCK	2	
20	515711850-00/5	BOLT LOCK	2	
21	515139865-00/7	BEARING HOUSING	2	
22	515104634-00/8	BEARING AXLE	4	
23	515768012-00/4	WASHER BASE	4	
24	515762008-00/8	NUT NYLOCK	2	
25	515701825-00/9	BOLT	2	
26	515139840-00/0	INDICATOR HOC	1	
27	515763010-00/3	NUT	1	
28	515711835-00/6	SCREW LOCK	2	
29	515756008-00/6	NUT LOCK	3	
30	515701030-00/6	BOLT LOCK	1	
31	515139765-00/9	WASHER	1	
32	515790001-00/9	SCREW LOCK	1	
33	515118038-00/6	SPRING (PRESSURE)	1	
34	515137420-00/3	ROD HOC ADJUSTMENT	1	
35	515777015-00/6	WASHER STAR	2	
36	515139754-00/3	WASHER (SPACER)	3	
37	515139429-00/2	BRACKET H.O.C.	1	
38	515213866-00/4	AXLE	2	
39	515139855-00/8	BEARING HOLDER	2	
40	515711830-00/7	SCREW LOCK	2	
41	515137410-00/4	ROD H.O.C.	1	
42	515780031-00/8	PIN COTTER	1	
43	515772009-00/4	WASHER SPRING	3	
44	515700840-00/9	BOLT	3	
45	515768014-00/0	WASHER	6	
46	515118459-00/4	SPRING	4	
47	515202608-00/3	WHEEL ASSY 8"	4	
48	515116021-00/4	CIRCLIP	4	
49	515116040-00/4	LOCK WASHER	4	

PRODUCT VARIANT

9645139-01 GB.F.I.NL.

9645139-09 D.

Where no application details are shown the part applies to all countries.